

Spring
Meadows

A stylized graphic of grass blades in a dark olive green color, positioned to the right of the word 'Meadows' and overlapping it.

Exceptional Living, Extraordinary Value



IT'S THE DETAILS THAT MAKE A DIFFERENCE

Surrounded by trees in a quiet community, Spring Meadows offers new custom home sites with large lots and room to breathe. It is uniquely designed to take advantage of the land's natural beauty and enhance the suburban neighborhood lifestyle with amenities that make living here easy. The homes feature custom design and craftsmanship with exquisite details and simple luxuries that make a house a home.

Centrally located in Plymouth, just minutes away are restaurants, movie theaters, golf and shopping. Downtown Minneapolis is an easy 15-minute drive and with its close proximity to highly sought after private schools and the award-winning Wayzata School District 284, there is no better location that gives such exceptional options for your children's education.

It's a community where you and neighbors can live and play. The beautifully appointed clubhouse makes a great gathering place for families and neighbors alike. Open year round, it features a wet bar, full indoor kitchen and outdoor grill station, flat screen TV, tables ideal for poker or Bunco and more. In summer, the doors open wide so you can enjoy the breeze and fresh air. The family-friendly swimming pool is an added amenity that will delight both the young and young-at-heart. From toddlers, to big kids, to adults swimming laps, the multi-use pool has something for everyone. Whether you're inside enjoying the fireplace or outside at the pool and seating area – it's a perfect place to host private events for family and friends or gatherings for the neighborhood.

THE PROMISE OF SPRING MEADOWS

Visit Spring Meadows or visit the website to see how Spring Meadows was carefully designed to give you more. More community. More architecture and landscaping. More amenities. Larger Lots. That's the promise of Spring Meadows.



Spring Meadows

Exceptional Living, Extraordinary Value



- 59 large lot single family community in Plymouth
- Located in Wayzata School District 284
- Private Neighborhood Pool and Clubhouse
- Extensive Landscaping at Entrance and Throughout the Development
- Custom home packages start at the mid 500's
- Available Now

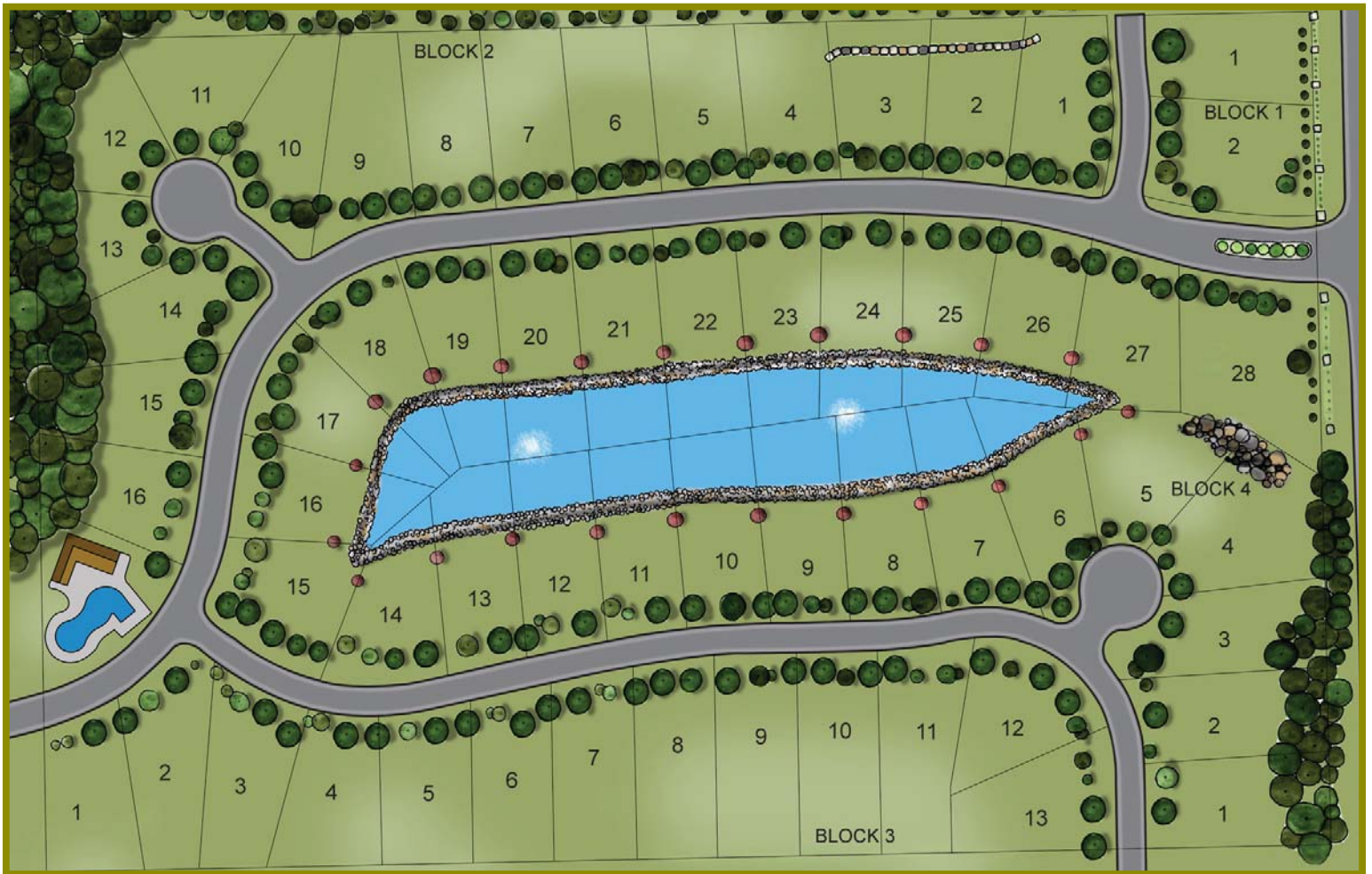

GONYEA
HOMES & REMODELING

Lane Larson
651.402.7297
gonyeahomes.com



Lesandra
763.350.7354
hansonbuilders.com



Jeremy Skogquist
763.441.1945
nihhomes.com



Scott Koppendrayer
763.268.9232
ldkhomes.com



SPRING-MEADOWS.COM

LOVE WHERE YOU LIVE

Spring Meadows offers custom homes designed by Minnesota's premier custom home builders who work with you to design the house of your dreams. Choice in design features and architectural detail will make your home unique and timeless with master-designed floor plans and options like large kitchens featuring distinctive wood cabinetry and granite, great rooms and living rooms with fireplace and built-ins, exquisite master bedrooms and bathrooms, and children's and guest bedrooms as well as bonus rooms that can be used for games, media or home theaters.

DETAILS

- Wooded and Pond Lots, Long Views and Quiet Streets
- Extensive Landscaping at Entrance and Throughout the Development
- Sidewalks Throughout the Neighborhood
- Driveways of Concrete or Brick Pavers Add to Each Home's Curb Appeal and Architecture
- Walk-Out and Look-Out Lots

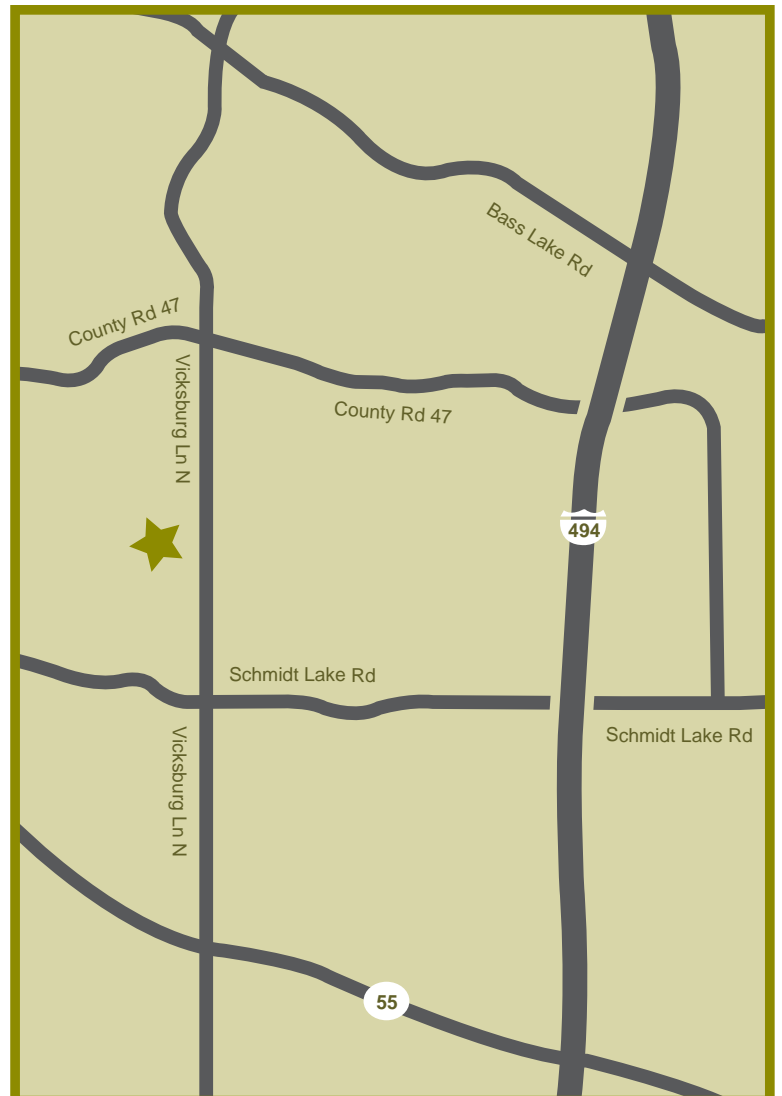



Another Fine Community Developed by Gonyea Company

SPRING-MEADOWS.COM